

Appendix 1:

Certificate of Title for Lot 1, Lot 2 and Lot 3 in DP 542707

Prior Title (Crown Grant)
Vol.11048 Fol.49

Vol. 11393 Fol. 198

Edition issued 21-8-1970



I certify that the person described in the First Schedule is the registered proprietor of the undermentioned estate in the land within described subject nevertheless to such exceptions encumbrances and interests as are shown in the Second Schedule.

Witness

Barnes

J. Watson
Registrar General.



PLAN SHOWING LOCATION OF LAND

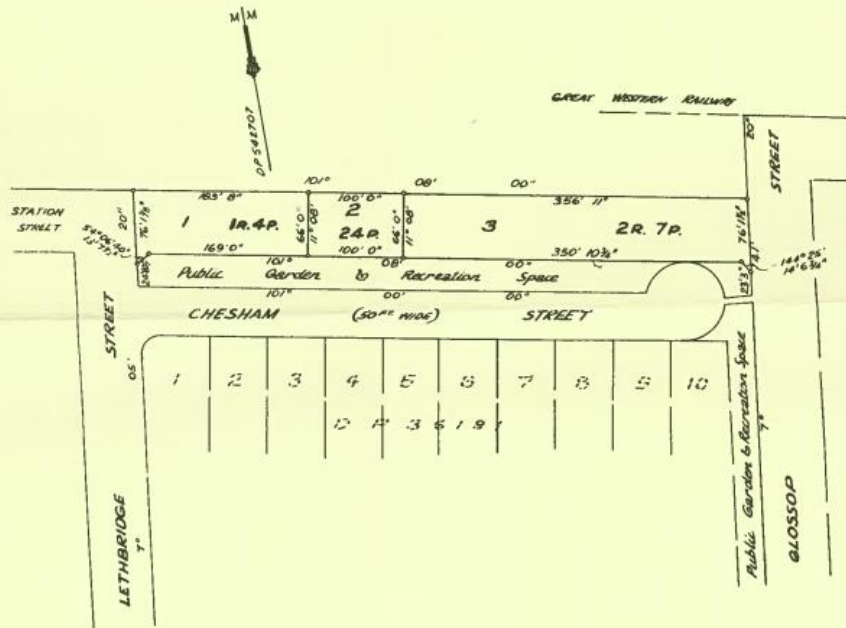

ESTATE AND LAND REFERRED TO

Estate in Fee Simple in Lot 1 in Deposited Plan 542707 at St. Marys in the City of Penrith Parish of Roxy Hill and County of Cumberland. EXCEPTING THEREOUT the minerals reserved by the Crown Grant.

FIRST SCHEDULE

THE COUNCIL OF THE CITY OF PENRITH.

SECOND SCHEDULE

1. Reservations and conditions, if any, contained in the Crown Grant above referred to.

J. J. J. J.
Registrar General

Registrar General

PERSONS ARE CAUTIONED AGAINST ALTERING OR ADDING TO THIS CERTIFICATE OR ANY NOTIFICATION HEREON

(Page 1) Vol. 11393 Fol. 199

NEW SOUTH WALES

CERTIFICATE OF TITLE

REAL PROPERTY ACT, 1900, as amended.

TORRENS TITLE
Register Book

Prior Title (Crown Grant)
Vol.11048 Fol.49

Vol. 11393 Fol. 199

Edition issued 21-8-1970



I certify that the person described in the First Schedule is the registered proprietor of the undermentioned estate in the land within described subject nevertheless to such exceptions encumbrances and interests as are shown in the Second Schedule.

Witness

Barnes

Jawatson
Registrar General.



PLAN SHOWING LOCATION OF LAND

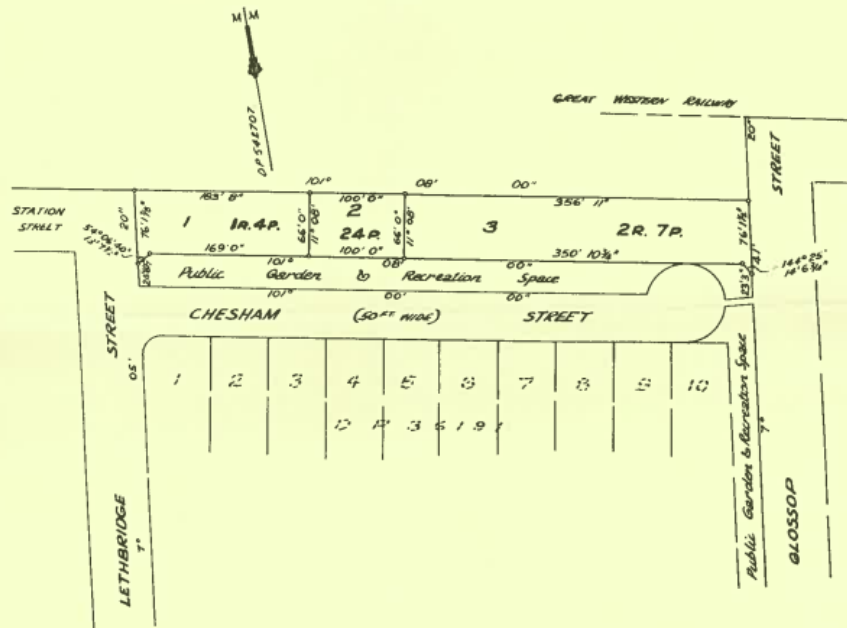

ESTATE AND LAND REFERRED TO

Estate in Fee Simple in Lot 2 in Deposited Plan 542707 at St. Marys in the City of Penrith Parish of Rooty Hill and County of Cumberland. EXCEPTING THEREOUT the minerals reserved by the Crown Grant.

FIRST SCHEDULE

THE COUNCIL OF THE CITY OF PENRITH.

SECOND SCHEDULE

1. Reservations and conditions, if any, contained in the Crown Grant above referred to.

Jawatson
Registrar General

NEW SOUTH WALES

CERTIFICATE OF TITLE
REAL PROPERTY ACT, 1900, as amended.

TORRENS TITLE
Register Book

Prior Title (Crown Grant)
Vol.11048 Fol.49

Vol. 11393 Fol. 200

Edition issued 21-8-1970



I certify that the person described in the First Schedule is the registered proprietor of the undermentioned estate in the land within described subject nevertheless to such exceptions encumbrances and interests as are shown in the Second Schedule.

Witness

Barnes

Jawatson

Registrar General.



PLAN SHOWING LOCATION OF LAND

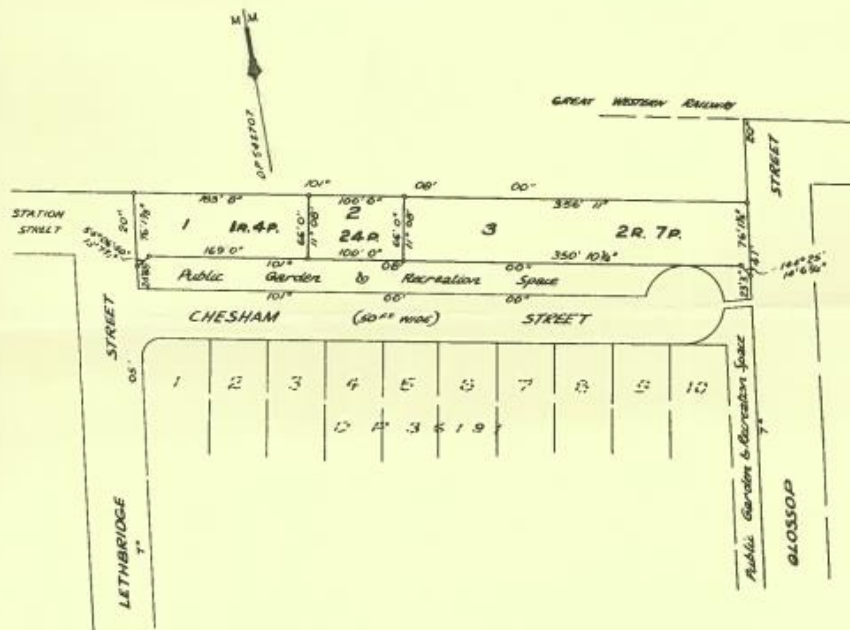

ESTATE AND LAND REFERRED TO

Estate in Fee Simple in Lot 3 in Deposited Plan 542707 at St. Marys in the City of Penrith Parish of Rooty Hill and County of Cumberland. EXCEPTING THEREOUT the minerals reserved by the Crown Grant.

FIRST SCHEDULE

THE COUNCIL OF THE CITY OF PENRITH.

SECOND SCHEDULE

1. Reservations and conditions, if any, contained in the Crown Grant above referred to.

Jawatson

Registrar General

PERSONS ARE CAUTIONED AGAINST ALTERING OR ADDING TO THIS CERTIFICATE OR ANY NOTIFICATION HEREON

(Page 1) Vol. 11393 Fol. 200